

# SEALEY

## 20 TONNE AIR OPERATED TROLLEY JACK - SINGLE STAGE

MODEL NO: **YAJ20B.V4**

Thank you for purchasing a Sealey product. Manufactured to a high standard, this product will, if used according to these instructions, and properly maintained, give you years of trouble free performance.

**IMPORTANT:** PLEASE READ THESE INSTRUCTIONS CAREFULLY. NOTE THE SAFE OPERATIONAL REQUIREMENTS, WARNINGS & CAUTIONS. USE THE PRODUCT CORRECTLY AND WITH CARE FOR THE PURPOSE FOR WHICH IT IS INTENDED. FAILURE TO DO SO MAY CAUSE DAMAGE AND/OR PERSONAL INJURY AND WILL INVALIDATE THE WARRANTY. KEEP THESE INSTRUCTIONS SAFE FOR FUTURE USE.



Refer to  
instructions



Wear Protective  
Footwear

### 1. SAFETY

- ✓ Disconnect jack from air supply before changing parts, servicing or performing any maintenance.
- ❑ **WARNING!** ensure correct air pressure is maintained and not exceeded.
- ✓ Keep air hose away from heat, oil and sharp edges. Check air hose for wear before each use, and ensure that all connections are secure.
- ✓ Ensure the jack is in sound condition and good working order. Take action for immediate repair or replacement of damaged parts.
- ✓ *Use genuine parts only. Unauthorised parts may be dangerous and will invalidate the warranty.*
- ✓ Use jack on level and solid ground, preferably concrete. *Avoid tarmac as jack may sink in.*
- ✓ Place wedges under wheels of vehicle.
- ✓ Ensure the vehicle handbrake is engaged, engine is switched off and transmission is in gear (or "Park" if automatic).
- ✓ Ensure minimum distance of 0.5m between vehicle and static objects such as doors, walls, etc., to allow for vehicle tilting.
- ✓ Only place jack under those lifting points recommended by vehicle manufacturer (*see vehicle handbook*).
- ✓ Check that the jacking point is stable and centred on the jack saddle and is free from grease and oil.
- ✓ Locate the jack in a suitable, well lit work area.
- ✓ Keep work area clean and tidy and free from unrelated materials.
- ✓ Use a qualified person to maintain or repair the jack's hydraulic system.
- ✗ **DO NOT** top up hydraulic system with brake fluid. Use hydraulic jack oil only.
- ✓ Ensure there are no passengers in the vehicle.
- ✓ Ensure all non-essential persons keep a safe distance whilst the jack is in use.
- ▲ **DANGER:** *Use the jack for lifting only, NOT for supporting the lifted load.*
- ✓ Use suitable capacity axle stands under the vehicle before proceeding with any task.
- ✗ **DO NOT** allow untrained persons to operate the jack.
- ✗ **DO NOT** operate the jack if parts are missing or damaged.
- ✗ **DO NOT** exceed the rated capacity of the jack.
- ✗ **DO NOT** allow the vehicle to move while supported by the jack, or use the jack to move the vehicle.
- ✗ **DO NOT** jack the vehicle if there is a risk of spillage of fuel, battery acid, or other dangerous substances.
- ✗ **DO NOT** work under the vehicle until axle stands have been correctly positioned.
- ✗ **DO NOT** use the jack for purposes other than that for which it is intended.
- ✗ **DO NOT** adjust the safety overload valve.
- ✗ **DO NOT** apply your body weight to the handle during jacking. The handle is only for moving the jack to and from the jacking location.
- ✗ **DO NOT** yank the hose from the air supply, and **DO NOT** direct air from the air hose at yourself or others.
- ✗ **DO NOT** use the jack if believed to have been subjected to abnormal load or shock. Inspect and take appropriate action.
- ✓ Ensure that there are no persons or obstructions beneath the vehicle before lowering.
- ✓ When not in use disconnect jack from the air supply, and store, fully lowered, in a safe, dry, childproof area.
- ❑ **WARNING!** *turn off air supply and de-pressurise the control nozzle before removing the pump unit from any installation or mobile system. Failure to comply with this instruction may damage the unit and will invalidate your warranty.*

### 2. INTRODUCTION

Ideal for workshop or roadside use, this jack takes the effort out of lifting heavy plant, tractors and commercial vehicles. For extra safety, features dead man's handle and multi-position locking handle. Supplied with extensions that close the gap between the saddle of the jack and the jacking point. See table for detailed specification.

### 3. SPECIFICATION

Model no: ..... **YAJ20B.V4**  
Max. capacity: ..... 20tonne  
Min. saddle height: ..... 230mm  
Max. height(including extension)/capacity:  
Stage 1 (mm/tonne): ..... 548/20  
Stage 2 (mm/tonne): ..... n/a  
Piston stroke: ..... 122mm  
Screw extension: ..... 105mm  
Extensions: ..... 20/60/90mm

Chassis length: ..... 575mm  
 Maximum Length : ..... 1270mm  
 Width without wheels: ..... 187mm  
 Overall width: ..... 322mm  
 Air consumption: ..... 9.5cfm  
 Working pressure: ..... 100-120psi

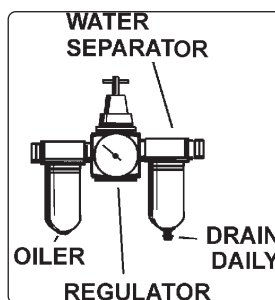

fig.1

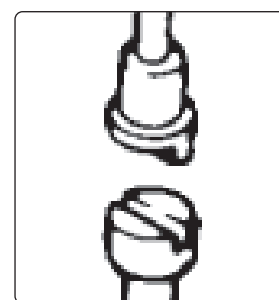

fig.2

#### 4. AIR SUPPLY

- 4.1. Ensure the jack pneumatic switch (or trigger) is in the "off" position before connecting to the air supply.
- 4.2. You will require an air pressure of at least 102psi (max 145psi) and an air flow of 9.5cfm to get the best performance from this jack. Use a compressor of 3HP or above.
  - ❑ **WARNING!** Ensure the air supply does not exceed 145psi while operating the jack. Too high an air pressure and unclean air will shorten the product's life owing to excessive wear, and may be dangerous causing possible damage and personal injury.
- 4.3. Keep the air hose between the compressor and the air jack as short as possible, and install an air filter and oiler, see fig.1.
- 4.4. Drain the air tank daily. Water in the air line will damage the jack.
- 4.5. Clean the air inlet filter screen weekly.
- 4.6. Line pressure should be increased to compensate for unusually long air hoses (over 8 metres). The minimum hose diameter should be 3/8" I.D. and fittings must have the same inside dimensions.
- 4.7. Keep hose away from heat, oil and sharp edges. Check hoses for wear, and make certain that all connections are secure.

#### 5. ASSEMBLY

- ❑ **WARNING!** Ensure the jack is not connected to the air supply before assembling.  
**REFER TO FIG.3 and FIG.X**
- 5.1. Slide the lower handle tube (fig.3.1) over the insert fitted to the upper tube. Fix in place with screw (fig.3.2).
- 5.2. Place the spring (fig.3.3) over the link rod (fig.3.4) and pass it through the hole in the bracket on lower handle tube (fig.3.1).
- 5.3. Thread the lock nut (fig.3.5) onto the link rod and screw the link rod into the upper link.
- 5.4. Pass the 'R' clip into the hole in the lower link rod to fix the arrangement in place (fig.3.6).
- 5.5. Slide the handle assembly into the hole in the yoke (fig.4) and fix in place using the screw (fig.4.1).
- 5.6. Check that when released from pressure, that the lower part of the link rod fits fully and securely into the holes in the jack base. If required, adjust the length of the link rod by using the threads and lock nuts to ensure full engagement with locating holes.
- 5.7. Connect the tubes coming out of the handle to the corresponding coloured tubes on the jack ensuring no leakage.
- 5.8. Fix extension mounting bracket (fig.5.1) using the 'U' brackets (fig.5.2) and supplied nuts.

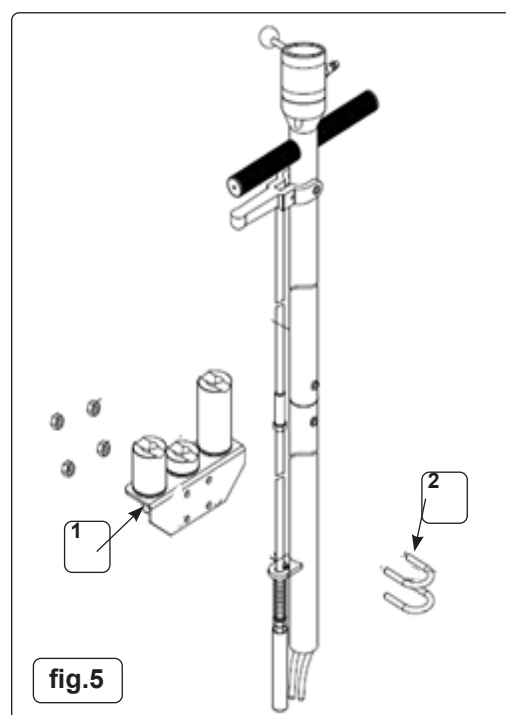
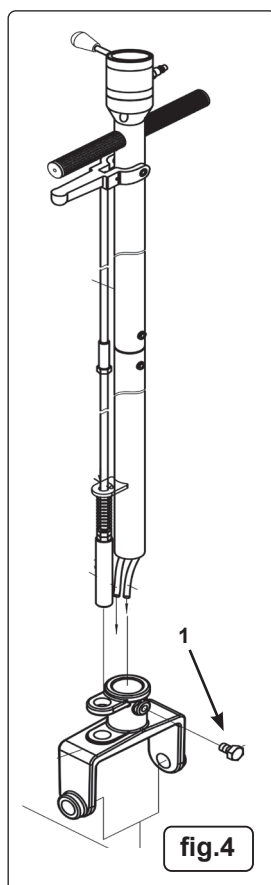
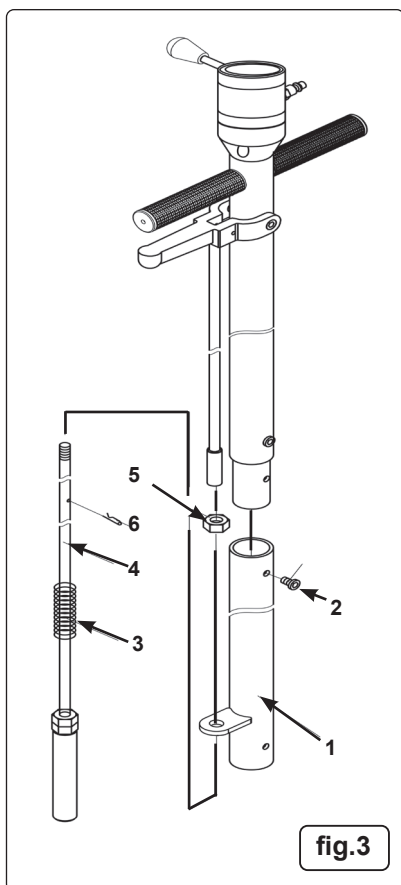

## 6. OPERATION

### REFER TO FIG.6

#### PREPARATION BEFORE USE.

- 6.8.1. You will require an air pressure of at least 100psi, (max 120psi) and an air flow of 9.5cfm to operate jack.
- 6.8.2. Check oil level before use (see Section 7.3)
- 6.8.3. Connect the air supply hose .

#### 6.1. ELIMINATE ANY AIR IN THE SYSTEM.

- 6.1.1. Before using the jack, purge the hydraulic circuit in order to eliminate any possible air that may have entered the system during transit. This can be achieved by raising and lowering the jack several times before first use

#### 6.2. USING THE JACK.

- WARNING!** Ensure you have read and understood the safety instructions in section 1 before commencing work.

- 6.2.1. Lift the lock lever, position the handle as required and release the lock lever. Ensure full and secure engagement of locking pin.

- 6.2.2. Position the Jack under the vehicle manufacturer's recommended jacking point. Refer to vehicle hand book.

- 6.2.3. Connect the quick coupler-male (on the cross valve) into the workshop air supply hose quick coupler-female. Turn on air supply.

- 6.2.4. Moving the handle of the selector valve (fig.7) to the left the jack will rise, moving the handle to right, the jack will descend. When the handle is in the middle position, the jack will stop operating.

- 6.2.5. When the vehicle has reached the desired height release the handle which will stop further air flow and hold the jack at the height to which it has been raised.

- 6.2.6. Place axle stands correctly in position and ensure section1 safety instructions are strictly applied before performing any task.

- 6.2.7. Ensure there are no persons or obstruction beneath the vehicle before lowering, and remove any axle stands.

- 6.2.8. To lower the jack, slowly move the selector valve clockwise and the jack will lower in a controlled manner.

- 6.2.9. Once completely lowered, remove the jack from under the vehicle. If you have finished using the jack, turn the air supply off, disconnect the jack from the air line and store the jack and air line accordingly.

**NOTE:** Always store the jack with the piston rod in the lowest position.

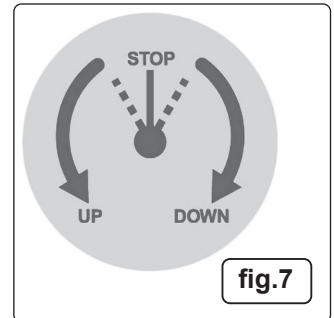

## 7. MAINTENANCE

**IMPORTANT: Only fully qualified personnel should attempt maintenance or repair.**

- WARNING!** Disconnect jack from air supply before changing parts, servicing or performing any maintenance.

- 7.1. When the jack is not in use, the piston rod must be in the lowest position to minimise corrosion.

- 7.2. Keep the jack clean and lubricate all moving parts on a regular basis.

- 7.3. To check oil level, fully lower jack. Remove the oil filler screw. The correct oil level should be up to the entrance of the oil filler opening. If oil level is low, fill as required.

**NOTE:** Use a good quality jack oil, such as SEALEY HYDRAULIC JACK OIL.

- WARNING! DO NOT** use brake fluid, or any fluid other than hydraulic jack fluid as this may cause serious damage to the Jack and will invalidate the warranty.

**IMPORTANT: NO RESPONSIBILITY IS ACCEPTED FOR INCORRECT USE OF THE MACHINE.**

Owing to their size and weight, hydraulic products should ideally be repaired by local service agents. We have service / repair agents in most parts of the UK. Before returning your product please call our technical helpline on **01284 757505** for advice and trouble shooting guidance.

## 8. TROUBLESHOOTING

PROBLEM	POSSIBLE CAUSE	REMEDY
Jack will not lift the load	1. Release valve not tightly closed.	1. Tighten release valve
	2. Low oil level	2. Check and add oil, see section 7.
	3. Defective or worn internal parts.	3. Discontinue use and contact a repair centre.
	4. Load exceeds maximum allowance.	4. Use a higher capacity jack.
Jack will not hold the load	1. Hydraulic unit malfunction.	1. Discontinue use and contact a repair centre.
Jack will not descend to minimum height, or will not remain in lowered position.	1. Reservoir oil overfilled	1. Check and ensure proper oil level.
	.	.
Jack will not lift to max. height.	1. Low oil level.	1. Check and ensure proper oil level, see section 6.2.
Jack will not function after above solutions have been tried.	1. Internal malfunction or structural damage.	1. Discontinue use and contact an authorised repair centre.



#### ENVIRONMENT PROTECTION

Recycle unwanted materials instead of disposing of them as waste. All tools, accessories and packaging should be sorted, taken to a recycling centre and disposed of in a manner which is compatible with the environment. When the product becomes completely unserviceable and requires disposal, drain any fluids (if applicable) into approved containers and dispose of the product and fluids according to local regulations.

**Note:** It is our policy to continually improve products and as such we reserve the right to alter data, specifications and component parts without prior notice. Please note that other versions of this product are available. If you require documentation for alternative versions, please email or call our technical team on [technical@sealey.co.uk](mailto:technical@sealey.co.uk) or 01284 757505.

**Important:** No Liability is accepted for incorrect use of this product.

**Warranty:** Guarantee is 12 months from purchase date, proof of which is required for any claim.

Sealey Group, Kempson Way, Suffolk Business Park, Bury St Edmunds, Suffolk. IP32 7AR



01284 757500



01284 703534



[sales@sealey.co.uk](mailto:sales@sealey.co.uk)



[www.sealey.co.uk](http://www.sealey.co.uk)